



athertons  
property & land

16 Springbrook, Clitheroe, BB7 1GZ  
£410,000

 3  2  1  B



# 16 Springbrook, Clitheroe, BB7 1GZ

An absolutely magnificent an unique extended semi-detached true bungalow built in 2020 on a large corner plot in this most sought-after development within Clitheroe. Internally, the property has been maintained to the highest standards boasting large extension to the side creating an extra bedroom/garden room, modern kitchen and bathrooms and neutral decor. The property lies under brick-faced and K-rend elevations and is set on a fabulous corner plot (one of the largest on the development) with open views to the front and side. The local amenities of Clitheroe are just a short walk away and the village of Whalley is only a five minute drive.

The accommodation affords: entrance hallway, bedroom two, bedroom one with walk in wardrobe, kitchen, three-piece family shower room and family lounge. Outside there are formal gardens to the front, side and rear and a two-car driveway. Early viewing is highly recommended to appreciate what this beautiful bungalow has to offer.

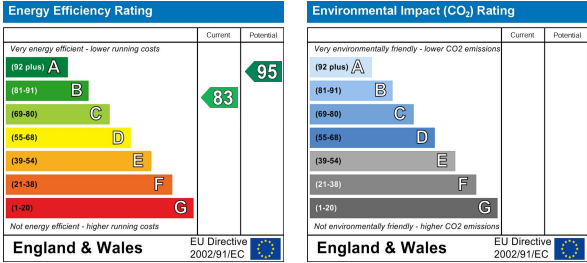
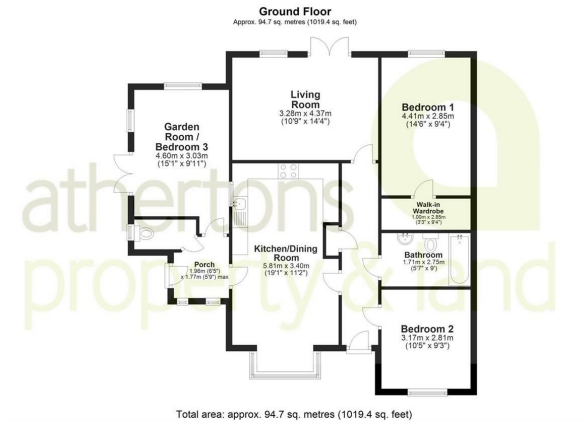
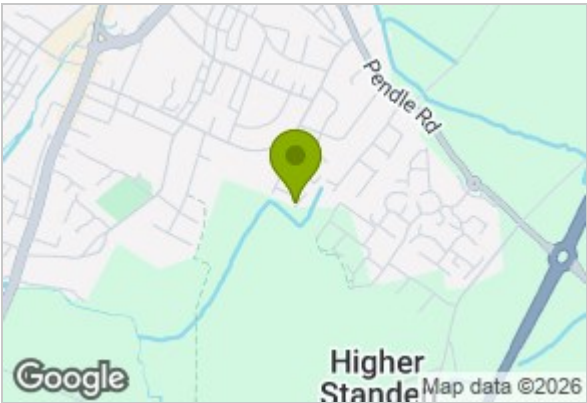

These particulars, whilst believed to be accurate are set out as a general outline only for guidance and do not constitute any part of an offer or contract. Intending purchasers should not rely on them as statements of representation of fact, but must satisfy themselves by inspection or otherwise as to their accuracy. No person in this firms employment has the authority to make or give any representation or warranty in respect of the property.